



**Specification Bulletin  
No. 205-207  
Mortairvent® CW**

**Mortairvent® CW | Full Wall Mortar Deflection & Rainscreen Technology for Masonry Cavity Wall Applications**

**DESCRIPTION**

The Mortairvent® CW Mortar Deflection & Ventilation System is a full cavity wall product that combines the benefits of rainscreen technology through the use of integrated mortar deflection, drainage and ventilation design. The result is an easy to install system that improves the overall performance of the interior wythe while also providing drainage and ventilation for the entire cavity wall.

Mortairvent® CW is available with a mortar deflection fabric or without depending upon the specific design recommendations of the project. The bonded mortar deflection fabric option provides an additional layer of prevention against mortar blockage of the cavity wall drainage plane and provides a dedicated airspace for ventilation and convective drying.

**BENEFITS**

- » Maintains a continuous airspace between the outer masonry wall and weather resistant barrier to facilitate moisture drainage and drying.
- » Reduces harmful mortar bridging in the cavity.
- » Mold & mildew resistant.
- » Contributes to LEED points.
- » 16” wide material is lightweight and easy to install between brick ties. Provides simple one-step installation as brickwork is completed.
- » Improves the overall performance of the entire cavity wall assembly.

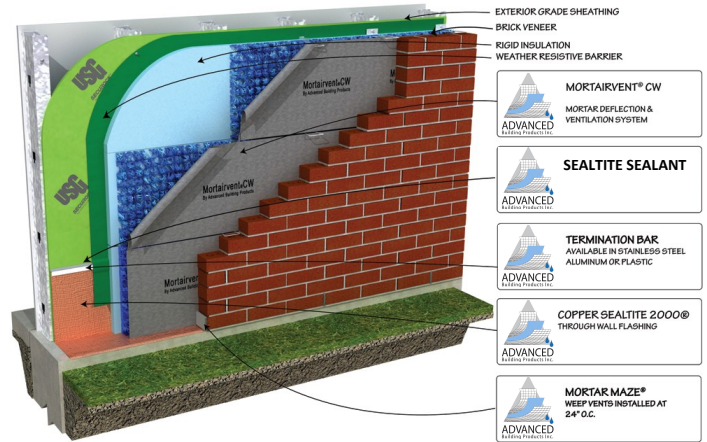

Securock® Glass-Mat Sheathing is a registered trademark of USG



Mortairvent® CW is easily installed by simply rolling the product horizontally between the brick ties.

PHYSICAL DATA	Mortairvent® CW 205	Mortairvent® CW 206	Mortairvent® CW 207
Core Material	Polypropylene	Polypropylene	Polypropylene
Thickness	.40 in. (10mm)	.80 in. (20mm)	1.6 in. (40mm)
Roll Length	40 ft. (12.19m)	50 ft. (15.24m)	25 ft. (7.62m)
Roll Width	16 in. (40.64cm) 39 in. (99.06cm)	16 in. (40.64cm) 39 in. (99.06 cm)	16 in. (40.64 cm) 39 in. (99.06 cm)
Roll Weight	5.0 lbs. (2.27kg) 12.5 lbs. (5.67kg)	5.6 lbs. (2.54kg) 14 lbs. (6.35kg)	5.6 lbs. (6.35kg) 14 lbs. (2.54kg)
Coverage Area	53 sq. ft. (4.92m <sub>2</sub> ) 130 sq. ft. (12.08m <sub>2</sub> )	67 sq. ft. (6.22m <sub>2</sub> ) 162.5 sq. ft. (15.09m <sub>2</sub> )	33.5 sq. ft. (15.09m <sub>2</sub> ) 81.25 sq. ft. (6.22m <sub>2</sub> )
UV Exposure	30 days	30 days	30 days

TECHNICAL DATA	Mortairvent® CW 205	Mortairvent® CW 206	Mortairvent® CW 207
Mortar Deflection, Ventilation, & Drainage Mat Options			
Mortar Deflection & Ventilation Material Thickness	.40 in. (10 mm)	.80 in. (20 mm)	1.60 in. (40 mm)
Density / Specific Gravity (ASTM D 792, Method A)	0.908 g/cm <sup>3</sup>	1.216 g/cm <sup>3</sup>	1.482 g/cm <sup>3</sup>
Porosity (open space) (ECTC TASC00197)	97.7 %	97.7 %	98.2 %
Mass / Unit Area (composite) (ASTM D 5261 / D 6566)	13.42 oz/sq.yd	12.15 oz/sq.yd	11.89 oz/sq.yd
Hydraulic Transmissivity (ASTM D 4716)	5.56 gpm/ft width	12.00 gpm/ft width	32.50 gpm/ft width
Air Transmissivity (ASTM D 4716, mod)	14.9 cu.ft/min/ft width	89.5 cu.ft/min/ft width	365 cu.ft/min/ft width
Flame Spread & Smoke Index (ASTM E 84)	Class A Fire Rated	Class A Fire Rated	Class A Fire Rated

## INSTALLATION INSTRUCTIONS

- » Apply a water resistant barrier over sidewall sheathing. Check local building codes and specifications for more information.
- » Install Mortairvent® CW over installed rigid foam insulation board. Starting at the base of the wall unroll Mortairvent® CW from right to left between brick anchors with the three-dimensional (blue) polymer matrix side against the water resistant barrier and mortar deflection fabric facing exterior of building. Unroll the next course in the same manner as the first.
- » Be sure to always butt the blue polymer material together without overlapping.
- » Mortairvent® CW should be installed horizontally between brick ties as exterior brickwork is completed so as to maintain captivation within the brick anchoring system.

Mortairvent® 10mm product meets the physical requirements of Section 9.27.2.2, Item 1b of the 2005 National Building Code of Canada and 2006 British Columbia Building Code.



**ADVANCED BUILDING PRODUCTS, INC.**  
 Phone: 800-252-2306 Fax: 207-490-2998  
 info@abp-1.com  
 www.advancedbuildingproducts.com



REV. 06/21