



ADVANCED DRAIN®

Polymeric Drainage Mat
FOR BELOW GRADE APPLICATIONS

Specification Bulletin
No. 700

ABP AdvancedDrain®

AdvancedDrain® | Prefabricated Composite Drain for Below Grade Applications

DESCRIPTION

ABP AdvancedDrain® is a drainage composite mat consisting of parallel geometric drainage channels backed with a nonwoven filter fabric designed to eliminate hydrostatic pressure from behind below grade foundation walls, retaining walls, planters, plaza decks and balconies.

The product is produced from an extruded polymer matrix of tangled, randomly oriented monofilaments. The polymer matrix is then shaped into a series of parallel, porous channels designed to allow flow in all directions. It is then attached (heat bonded) to a polyester nonwoven filter fabric designed to prevent soil or sediment from entering the matrix of the system, while providing ample flow of water.

Applications

- » Residential and Commercial foundation walls
- » Retaining walls
- » Planters
- » Plaza decks
- » Horizontal balcony drainage
- » Sidewall Applications
- » Green Roof applications

Features and Benefits

- » Filtration and drainage in one package.
- » Lightweight, easy to handle and install.
- » Installation in either vertical or horizontal direction.
- » Simple installation with either construction adhesive or termination bar.
- » Sufficient fabric overlap for sealing adjacent panels with construction adhesive to prevent soil intrusion at the joints.
- » Polymer core resistant to most known solvents and chemicals including acids and bases.
- » Convenient working width and roll length.

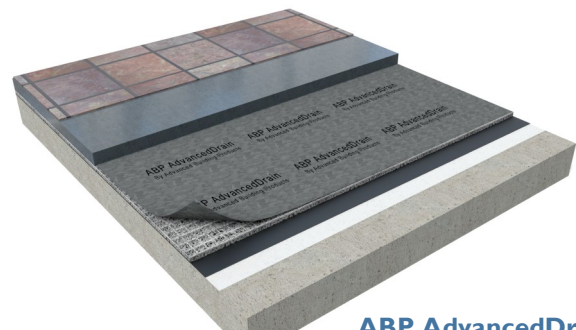
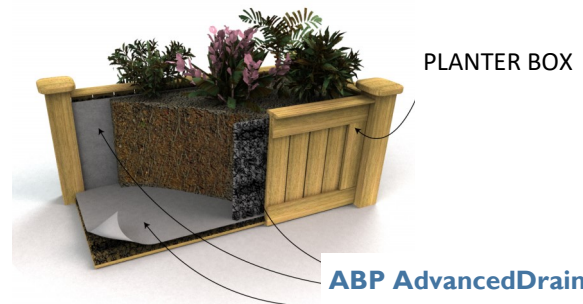
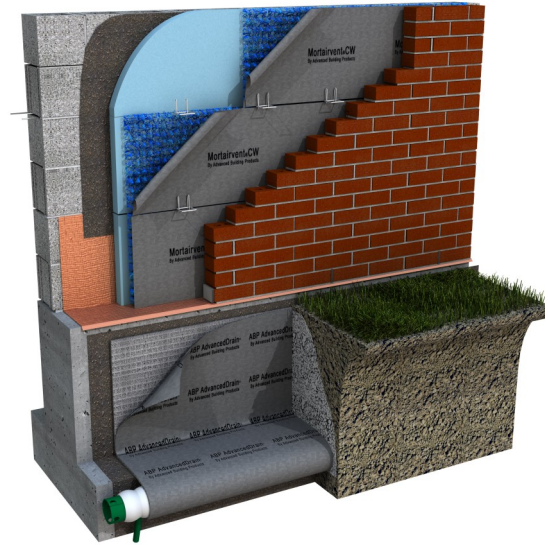

ADVANCED BUILDING PRODUCTS, INC.

Phone: 800-252-2306 Fax: 207-490-2998

info@abp-1.com www.advancedbuildingproducts.com

Description	Advanced Drain 0.125"	Advanced Drain 0.25"	Advanced Drain 0.40"	Advanced Drain 0.50"
Core Weight — ASTM D5261 (oz/yd2)	11.4	14.3	17.4	20.0
Composite Weight — ASTM D5261 (oz/yd2)	14.4	17.2	20.4	22.9
Core Thickness — ASTM D5199 (in)	.125	.250	.400	.500
Composite Thickness — ATSM D5261 (oz/yd2)	.145	.260	.410	.510
Fabric Weight — ASTM D5261 (oz/yd2)	2.9	2.9	2.9	2.9
Core Width (in)	39.5	39.5	39.5	39.5
Fabric Overlap (in)	3.0	3.0	3.0	3.0
Roll Length (ft)	150	135	100	75
Roll Area (sq ft)	494	445	330	247
Roll Weight (lbs)	47	54	47	40

Flow Rates								
Soil Depth (in.)	Wall Pressure (psf)	Seepage (gal/min/ft)			Drain Flow (gal/min/ft)			
		Sandy	Silty	Clay	.125	.25	.40	.50
10	500	0.15	0.015	0.0015	3.8	12.2	21.5	28
15	750	0.22	0.022	0.0022	3.4	11.5	20.0	22
20	1000	0.29	0.029	0.0029	3.0	10.5	17	16
30	1500	0.43	0.043	0.0043	2.6	8.4	11	10
40	2000	0.62	0.063	0.0063	2.3	6.3	5.5	5



- All values are nominal.
- All rolls are stretch wrapped for shipment.
- Roll weight includes package.
- UV Exposure is rated at 30 days.



ADVANCED BUILDING PRODUCTS, INC.
 Phone: 800-252-2306 Fax: 207-490-2998
 info@abp-1.com
 www.advancedbuildingproducts.com



REV. 08/18