

5/9/22

SPACE NEEDS BASED ON DISPLACEMENT FROM NOTCH ROAD

CURRENT USES AT NOTCH ROAD MUNICIPAL CENTER

- Three finance offices
- One registrar office
- Registrar storage area
- One common work space with copier and fax
- One Selectmans office
- Two meeting spaces
- One dedicated room for recreation in the lower level
- Storage on lower level

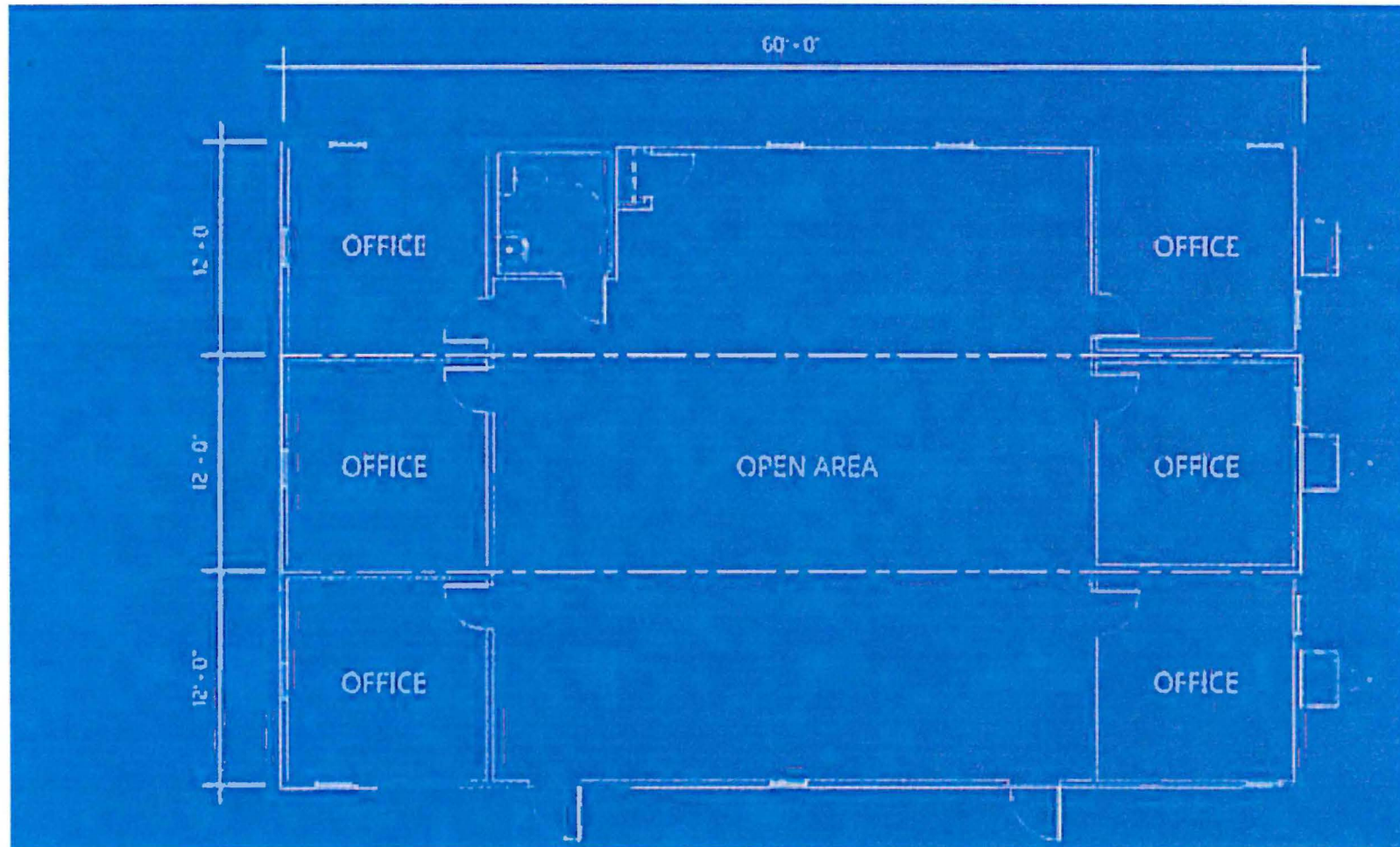

Dimensions

64' Long (including hitch)

60' Box size

36' Wide

(6) 12' x 12' Private Offices

1,296 sq. ft. Common Area

