



Department of Planning & Community Development (DPCD) August 2025 Newsletter



Governor Healey Announces Housing Funds for Suffolk Downs

On July 25th, [Governor Healey arrived at Suffolk Downs](#) to award HDIP funding to HYM's [Portico](#) project, which will bring 473 new units of housing to Suffolk Downs. Revere unlocked the HDIP tool earlier in 2025, when the City Council voted to create an HDIP zone at Suffolk Downs, Shirley Avenue, and the Green Street neighborhoods. To learn more about HDIP zones and what they mean for Revere, read this [article!](#)



Affordable shared rides for Revere and Chelsea.

Get to work, school, and errands, or connect to the MBTA with RC Link. Rides cost \$2 or less and are available Monday to Friday 7am - 7pm. Book a ride in the app or by calling 339-331-1995.

All rides are FREE thru Sep 19!

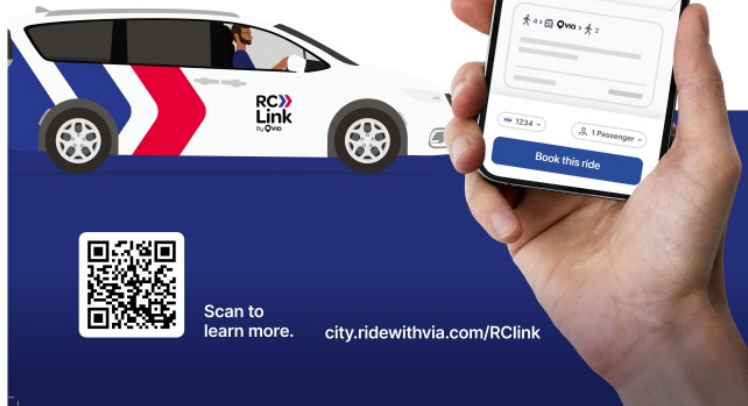

Revere Rides with New RC Link

The City of Revere, in partnership with the City of Chelsea, has launched its Micro-transit service between the two cities on August 19th, 2025. This service provides last-mile connections in complement to MBTA bus and transit services.

Revere and Chelsea residents, visitors, and employees can ride the RC Link to destinations within the cities for \$2.00 a ride, \$1.00 for seniors and students. Service is available from Monday through Friday from 7AM to 7PM. For more information, visit the RC Link website [here](https://city.ridewithvia.com/RClink).

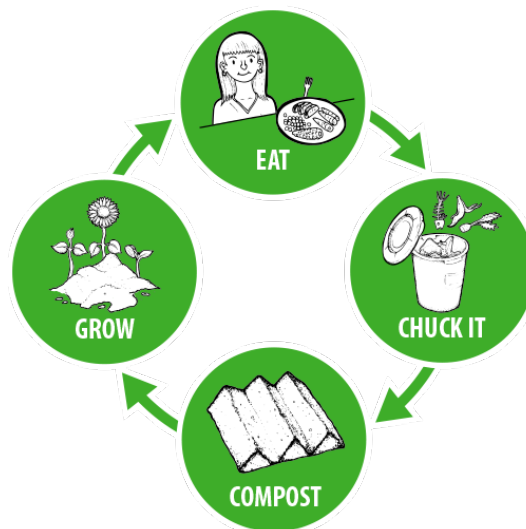

Revere's Curbside Composting Pre-Enrollment Registration is Now LIVE!

The City of Revere is thrilled to officially launch its curbside composting program with [Garbage to Garden](#), now the City's Preferred Composter. This fall, residents will gain access to free starter kits and discounted weekly curbside food waste pickup, helping households reduce trash and support a more sustainable future.

Launch Timeline Highlights:

- Now through September: Pre-enrollment period — we're aiming for 250 households to enroll before service begins
- October 1 (Target Launch): Curbside service begins for enrolled residents — *Organic waste pick-up will be aligned with trash day*

Go green and enroll [here!](#) The first 1000 customers will receive a complimentary starter kit, valued at \$34.99.



--REVERE: MALDEN STREET--

NO-HEAT WALK AUDIT

We're looking to gather feedback and identify possible opportunities for ways to make places cooler, whether with more trees, shade structures, or something else you might suggest.



SEPTEMBER 17TH | 3:00 PM - 4:30 PM

1.3 MILE WALK

STARTING LOCATION - LOOK FOR TENT!
DISALVO PARK, SUSAN B ANTHONY SCHOOL

RSVP, Visit walkmass.org/walk-audits

Request interpretation by email at jgp@walkmass.org

Hosted by WalkMass with Boston MPO

Rain or shine, unless severe weather.

NO HEAT Walk Audit on September 17th

Join the City of Revere, Boston MPO, and Walk Massachusetts for a Walk Audit of Malden Street to the Northern Strand Trail. The Walk Audit will identify ways to reduce heat stress and enhance pedestrian safety on Malden Street. The audit will begin at DiSalvo Park at 3:00 PM. Visit [here](#) to learn more or sign up.

The project, led by the Boston MPO, also has a survey that asks participants about how to build cooler, more walkable corridors in the city. Share your thoughts below!

English - bit.ly/heat-eng

Spanish- bit.ly/heat-es



Aucella Court Community Art and Paint Day Set for September 13th

The City of Revere has contracted Neighborways Design Consultants to design the Aucella Court entryways on Broadway, Central Avenue, and Sprague Street. The design will facilitate pedestrian crossings and wayfinding in the parking lot, while integrating the existing color and branding proposed for the Broadway District.

The art will be installed with the help of Revere residents! Please join us on September 13th at 9:00AM to participate in a community paint day to beautify Aucella Court!

To learn more about the project and to register as a volunteer, please scan the flyer above or fill out the form [here](#), or contact John Festa at 781-286-8194 x 20318.

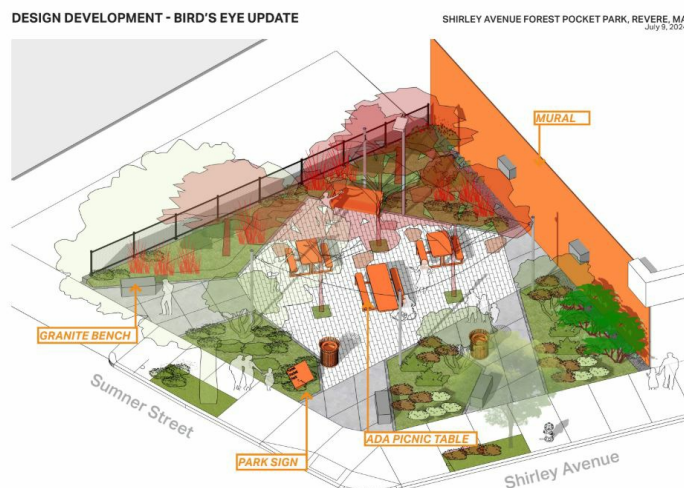

Bringing the Forest to Shirley Ave

Revere's dense landscape leaves little room for green space and urban forestry. To combat this, a "Forest Pocket Park" is being developed within the Shirley Avenue neighborhood. This site (located on the corner of Shirley Ave and Sumner Street) is being developed as a green escape in the heart of this bustling district, allowing folks to enjoy passive recreation and greenery. Construction on this site has been started and will be complete by this fall. The site will also include a mural to complement the space.

Questions about the Pocket Park? Contact Elle Baker at ebaker@revere.org.



Blue Cross Blue Shield of Massachusetts Offers \$20 Bluebikes Credit

[Blue Cross Blue Shield](#) is offering a \$20 free credit offer to help individuals impacted by the upcoming MBTA closures. This credit complements the City of Boston's "free unlocks" offer tied to select MBTA closures.

How it works: Beginning September 3rd, redeem your credit by using the code **BLUECROSSMAMBT3** under "Rewards" in the Bluebikes app. The credit can be applied toward any combination of Bluebikes trips across all 550 stations. The credit is valid for 12 months from the time of redemption.



Long-Awaited Fitzhenry Square Transformation Scheduled to Start This September

The transformation of Fitzhenry Square into an official dog park is a long-awaited improvement to the current conditions of the makeshift dog park. Many residents have been advocating for improvements to this space to reduce the slope and make it more comfortable and safe for dogs and their caregivers. This month the project was awarded to Lowell-based Greener Group. Construction is scheduled to begin in September, with a goal to be open by the fall. The project is scheduled to begin in September and will be open to the public in the fall. We hope to see you and your pups there later this year!

For questions about the project, contact Elle Baker at ebaker@revere.org.



City Hosts Tour with The Builder Coalition

On July 31st, the City of Revere hosted a rainy-day tour in partnership with [The Builder Coalition](#), a non-profit that aims to increase access and diversity in the real estate sector. The tour, which included government officials, realtors, architects, developers, and other real estate professionals, was an opportunity for Revere to showcase our developmental values, such as:

- Affordability: How to encourage development that is affordable to the average Revere resident
 - Open Space and Amenities: How to increase access to green space and amenities for Revere residents
 - Quality design: How to design projects in a way that respect the context of our neighborhoods
-



Regional Data Profile Highlights Revere's Traffic Safety Needs

As part of their [Vision Zero Plan](#), the Boston MPO released a data profile of the major

traffic safety issues across the region. In [Revere's profile](#) (beginning on page 38), they summarize some of the main traffic safety issues on Revere streets and highlight the top 5 corridors for safety issues. To no surprise, 4 of those 5 corridors are state-owned roadways.

This tool will be used for both local and regional governments to plan traffic safety interventions, and most importantly unlock federal [Safe Streets and Roads for All \(SS4A\)](#) funding.



Work Scheduled to Begin on Flaherty Square

Improvements are scheduled to begin at Flaherty Square in mid-September to repurpose the underutilized space into a modern and inviting open space with native plantings and seating for passive recreation. The project is scheduled to open to the public this fall. If you have any questions, contact Elle Baker at ebaker@revere.org.

If you are interested in receiving monthly communication from the Department of Planning and Community Development, please join our mailing list below.

**Join Our Mailing
List**

City of Revere | 281 Broadway | Revere, MA 02151 US

[Unsubscribe](#) | [Update Profile](#) | [Constant Contact Data Notice](#)



Try email marketing for free today!